

PROPOSED CONSTRUCTION OF A TYPICAL 900MM CROSS CULVERT

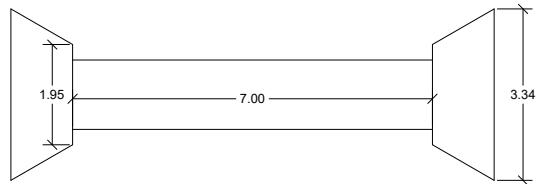

PLAN OF THE CULVERT

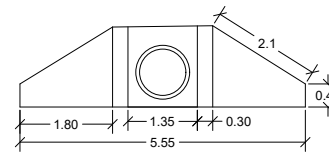

Front view of the culvert

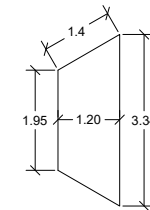

Details of RC Aprons

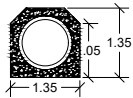

Section through x-x

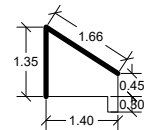

Dimensions of Wingwalls

	TOTAL AREA	Volume of concrete	No.	Total area	Total volume
WINGWALLS	1.26	0.328	8	10.08	2.621
APRONS	3.174	0.825	4	12.696	3.30
BED	1.95	0.507	19	37.05	9.633
SURROUND/HOUNCH	3.768	0.98	19	71.592	18.614
HEADWALLS/TOE BEAM	0.585	0.152	8	4.68	1.216
Total to be reinforced with BRC A142 for the structure				136.098	
Total Volume of concrete required for the structure					35.384
Excavation in soft material for the structure.					
APRONS	3.174		4	12.696	
BED	1.95		19	37.05	
Total volume of excavation for the structure.				49.746	99.492

NOTES:

1. ALL DIMENSIONS ARE IN METERS UNLESS STATED.
2. REINFORCEMENT TO BE AS PER THE BRITISH STANDARDS
3. HARDCORE TO BE OF GOOD SELECTED MATERIAL
4. REINFORCEMENT SHOULD BE PLACED 150MM C/C
5. EXCAVATION DEPTH WILL BE DETERMINED ON SITE.
6. PAYMENT OF THE WORKS WILL BE DONE BASED ON MEASURED WORKS.

CLIENT: KCEP-CRAL	DRAWN BY	PROPOSED INSTALLATION OF 900MM CROSS CULVERTS IN MWIBA ROAD.	NOVEMBER 2018
MINISTRY OF AGRICULTURE, LIVESTOCK FISHERIES AND IRRIGATION	D. S TELIENY (P.Eng. Techn)		NZOIA COOP WAREHOUSE
	DRWG NO. 008/2018		