

# PROPOSED CONSTRUCTION OF A TWIN CULVERT ACROSS BARKEIYET RIVER

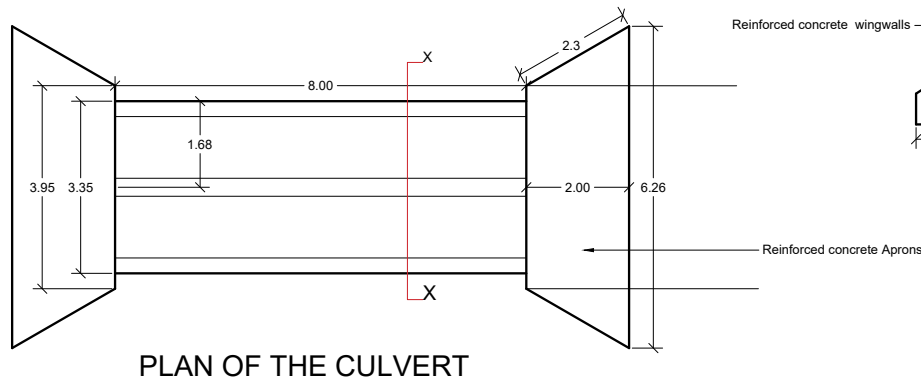

PLAN OF THE CULVERT

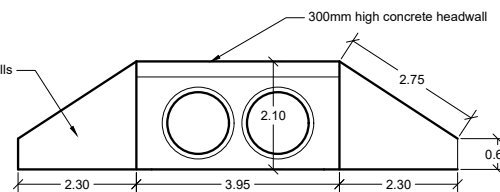

Front view of the culvert

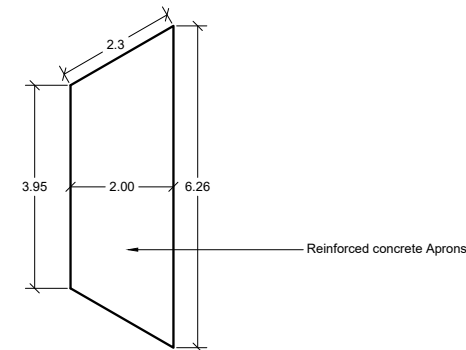

Details of RC Aprons

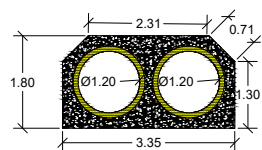

Section through x-x

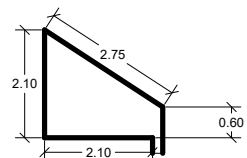

Dimensions of Wingwalls

	TOTAL AREA	Volume of concrete	No.	Total area	Total volume
WINGWALLS	2.835	0.737	4	11.336	2.948
APRONS	10.21	2.655	2	20.42	5.309
BED	3.95	8.216	8	31.6	8.216
ABUTMENT WALLS	3.768	0.98	8	30.144	7.84
Total to be reinforced with BRC A142 for the structure				63.635	
Total Volume of concrete required for the structure					24.311
Excavation in soft material for the structure.					
APRONS	10.21			10.21	
BED	3.95		8	31.6	
Total volume of excavation for the structure.				41.81	112.887

## NOTES:

1. ALL DIMENSIONS ARE IN METERS UNLESS STATED.
2. REINFORCEMENT TO BE AS PER THE BRITISH STANDARDS
3. HARDCORE TO BE OF GOOD SELECTED MATERIAL
4. REINFORCEMENT SHOULD BE PLACED 150MM C/C
5. EXCAVATION DEPTH WILL BE DETERMINED ON SITE.
6. PAYMENT OF THE WORKS WILL BE DONE BASED ON MEASURED WORKS.

CLIENT: KCEP-CRAL

DRAWN BY

BARKEIYET RIVER CROSSING  
IN MOSOP SUB COUNTY

NOVEMBER 2018

MINISTRY OF AGRICULTURE,  
LIVESTOCK FISHERIES AND IRRIGATION

D. S TELIENY (P.Eng. Techn)

DRWG NO. 007/2018

PROPOSED 1200MM TWIN CULVERT

KABISAGA  
WAREHOUSE